

ONE SMALL
CHANGE CAN
MAKE A **BIG**
DIFFERENCE



 **SYR**
switch



REIMAGINED RECYCLED PLASTICS

We use our manufacturing expertise and state of the art production techniques to minimise product waste and maximise product life expectancy whilst creating a product that will support the environment through:

- > Reducing water consumption
- > Reducing plastic waste over its lifetime
- > Reducing chemical usage
- > Recycling materials destined for landfill
- > Reducing volume of waste being sent to landfill



Making it easy to switch to more sustainable choices.

When you see the SYR Switch logo you can be confident that you are purchasing a product that directly supports sustainability over its whole life cycle.

The world's natural resources are finite, and some are in very short supply. SYR recognised that in manufacturing products made using recycled plastic they could reduce the use of fossil fuel hydrocarbons, reduce energy consumption and lower carbon emissions.

The SYR SWITCH range uses waste materials destined for landfill, recycled plastics, regrind plastics and thoughtful design to allow you to be kinder to the environment, without compromising your pocket or the quality of work completed.

One small change – one big difference.

Contents

MOPPING SYSTEMS	01-05
INTERCHANGE HANDLES	06
SYRSORB MOPHEADS	07
SPRAY FLAT MOPPING	08-11
SAFEGUARD-R	12-13
SOCIAL DISTANCING	14
SPILL MANAGEMENT	16
MULTI-SURFACE TOOL	17-18
FLOOR MAINTENANCE	19-20

Our Rating System

Our products are designed to help towards creating a more sustainable environment.

They do it so well and in so many different ways that we use these simple icons to help you identify how each product helps.



Water Saving



Recycled Content



Lifetime Value



Recyclable



Chemical Saving



Landfill Prevention



QR Codes

Many of our products have supporting video material available which will give further insight into the product and its uses. Scan the provided QR code to find out more.



Lucy
professional

Lucy-R Oval Bucket



Extra tough mop bucket with easy clip on/off sieve. Made using recycled plastic. Compatible with socket mops.

FEATURES

- > 5 litre working water
- > Color-coded strong pick up and go handle to avoid cross contamination
- > Incredibly durable and tough
- > Built in moulded socket mop sieve
- > Made from recycled plastic wherever possible

Coming soon



Our mopping systems are unmatched in ergonomics, strength and sustainability.

The same durability as our normal mopping systems, but now made with recycled plastic.

Introduced in 1992 the Long Tall Sally (LTS) has an iconic shape which is recognised globally. The taller, vase shaped design can be found throughout many blue chip

companies. It not only looks fantastic, but its unique shape uses less water per fill and keeps water cleaner for longer. The ergonomic operating height, combined with wringer, prevent awkward postures and reduce musculoskeletal disorders, a common issue in the cleaning industry. It is also incredibly durable, outlasting everything else. Originally designed in 1997, our TC20 mopping system has had plenty of facelifts in its time, but has now become an industry leading, professional solution to floor cleaning. Every element of the bucket has been considered to produce an efficient tool that can be operated with minimum strain and maximum results.

Both our LTS and TC20 are manufactured here in the UK. Our advanced tooling and manufacturing creates less than 1% waste plastic when moulded, which is then collected and immediately recycled to help create our LTS R and TC20 R. This system of manufacturing ensures 0% waste within the factory environment.

MADE USING RECYCLED PLASTIC



FEATURES

- > Easy glide 80mm rubber swivel castors
- > Ergonomic wringer
- > 13 litre working water
- > Color-coded strong pick up and go handle to avoid cross contamination
- > Incredibly durable and tough
- > White clean and bold print
- > Made from recycled plastic wherever possible

One TC20-R Mopping System will reduce virgin plastic production by 92% over its expected lifetime - this equates to 9kg of virgin plastic not being manufactured for every TC20-R sold.*

Creating 109 TC20-R mopping systems prevents one metric tonne of virgin plastic being produced - saving 5,774 Kwh of energy, 16.3 barrels of oil, 98 million BTU's of energy and 3000 kg of CO2.

TC20-R Mopping Combo



Our compact mopping solution, with a strong carry handle and sturdy legs with 80mm castors & colour coded wringer. Accepts Kentucky mops from 340g to 510g.

- S0332291 - Red ●
- S0332292 - Blue ●
- S0332293 - Green ●
- S0332294 - Yellow ●



*when compared to similar mopping system

Interested in bespoke bucket prints? Please visit syrcclean.com/bucketprinting for more information

syrcclean.com



LTS-R Mopping Combo



Superb Long Tall Sally (LTS) professional quality complete with ergonomic wringer. Highly durable mobile bucket wringer combo for Kentucky versatile everyday mopping.

S0327291 - Red ●
 S0327292 - Blue ●
 S0327293 - Green ●
 S0327294 - Yellow ●

The elongated bucket depth reduces dirt agitation in the working water, but requires 30% less water to fill*, keeping water cleaner whilst saving thousands of litres of water every year.

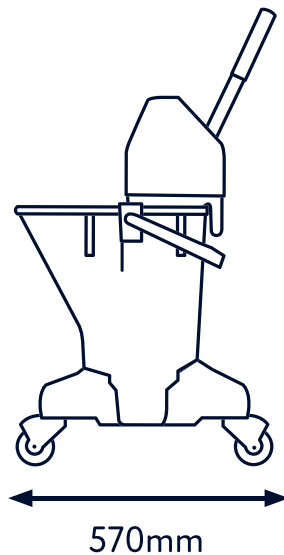

1055mm

570mm



One LTS-R Mopping System will reduce virgin plastic production by 90% over its expected lifetime - this equates to 10kg of virgin plastic not being manufactured for every LTS-R sold.*

Creating 100 LTS-R mopping systems prevents one metric tonne of virgin plastic being produced - saving 5,774 Kwh of energy, 16.3 barrels of oil, 98 million BTU's of energy and 3000 kg of CO2.

*when compared to similar mopping system

SWITCH TO A MORE SUSTAINABLE FUTURE

> The LTS-R Combo

- 1 Made from recycled plastic wherever possible
- 2 0% production waste during manufacturing
- 3 Vase shaped bucket reduces water volume required for each fill by at least 30%
- 4 Deep sump grid construction effectively traps dirt, keeping the water above cleaner for longer
- 5 Water depth allows mop to be thoroughly cleaned without disturbing the trapped dirt below
- 6 Colour-coded wringer and carry handle prevent cross contamination in sensitive cleaning areas
- 7 Incredibly durable recycled plastic due to unique polymer composition
- 8 Comfortable operating height reduces musculoskeletal disorders
- 9 Ergonomic wringer requires very little pressure for water release
- 10 'Made from recycled plastic' decal conveniently located on bucket
- 11 Easy glide 80mm rubber swivel castors for quiet and smooth motion

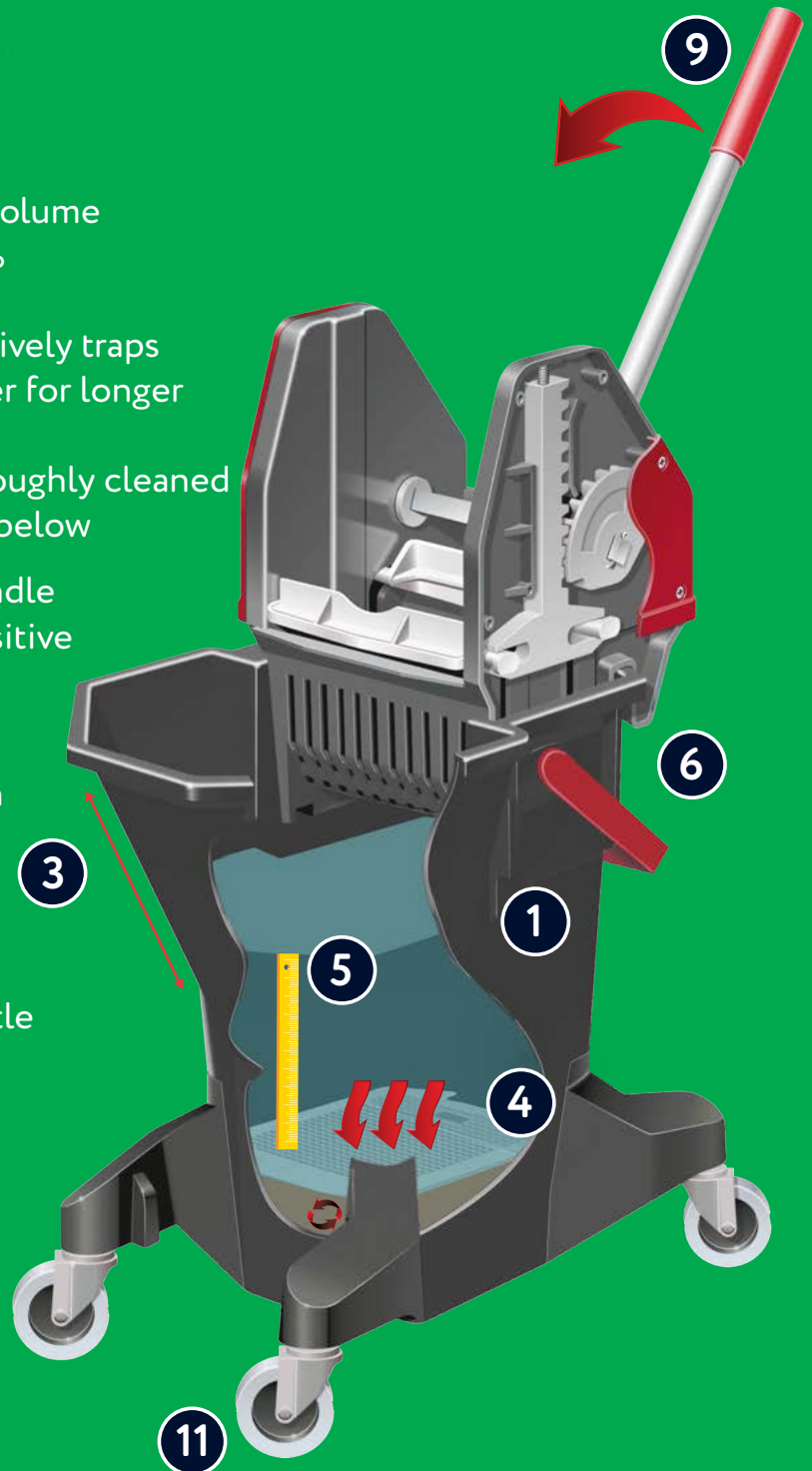



Our Interchange System

The SYR interchange system allows multiple tools to be swapped easily onto one handle, greatly reducing the volume of handles required. Interchange fixings also allows our heavy duty handles to be used in a variety of different cleaning environments with the clever use of adaptors, ensuring as little as possible ends up in landfill.



Unique ferrule collar design to strengthen Interchange connection and increase durability

54" Interchange Handle



Heavy duty aluminium mop handle with interchange fitting. Perfect length for a wide range of cleaning and sweeping tasks.

- 920044 - Red ●
- 920043 - Yellow ●
- 920045 - Blue ●
- 920047 - Black ●
- 920046 - Green ●

Equipment Cost

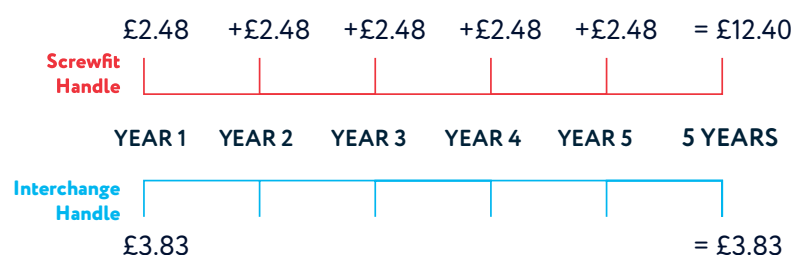

Cost reduction of 69%

Based on industry average costs



SYRSorb Mopping

Originally made from material destined for landfill, our lint free, SYRSorb range is great step towards a greener cleaners cupboard. Tests show 100% absorbency from first use and improved pick up and release compared to standard cotton mops.



Kwiki II Kentucky Mop Holder

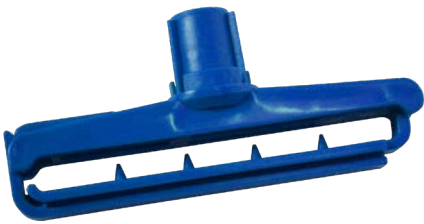

Interchange compatible clip-style holder for Kentucky mops.

- SS706 - Red ●
- SS707 - Blue ●
- SS708 - Green ●
- SS709 - Yellow ●



SYRSorb Kentucky Mop

Highly absorbent synthetic mop that is easily attached to the Kwiki II holder. Launderable up to 10 times.

- SS015 - Midi 175g / 6.17oz
- SS016 - Maxi 210g / 7.40oz



Clip it Socket Mop Holder



Perfect for SYRSorb Socket mops. Interchange compatible.

- SS713 - White



SYRSorb Clip It Socket Style Mop

Highly absorbent synthetic mop that is easily attached to the Clip-it holder. Launderable up to 10 times.

- 994025 - 80g / 2.82oz
- 994026 - 100g / 3.52oz
- 994027 - 120g / 4.23oz

Use 97% less water than a traditional mop & bucket.

TIME IT TAKES TO CLEAN 1000 SQ FEET

Trad Mop



25 Mins

Spray Flat Mopping



13 Mins

Nearly double the efficiency

Compared to a traditional mop head, microfiber mops can reduce bacteria by 96 percent.

A Sustainable Way to Clean Every Day

Spray flat mopping systems provide controllable moisture to give smear free dry floors. In addition to improving labour productivity and additional worker safety, the direct application of uncontaminated cleaning solution reduces chemical use and virtually eliminates cross contamination and wastewater.

At SYR we created our professional 'Rapid Mop' and 'Dual Mop' Spray flat Mop Systems, both of which are light, mobile and ideal for daytime cleaning in lightly soiled areas. Water is simply poured into the 480ml internal reservoir, which is then dispensed via a thumb operated button on top of the handle. The water is pumped forwards out of three jets placed above the pad holder, as and when required, ensuring only the perfect amount of water is distributed.

It is essential when 'cleaning with less' that a good level of performance is maintained to ensure resource efficiency – our large range of compatible, colour coded microfiber flat mops ensure that we are able to provide solutions for a range of everyday jobs. Chemical use reduction, combined with labour savings and waste water elimination allows our SYR Spray flat Mop systems to offer a more sustainable cleaning process.



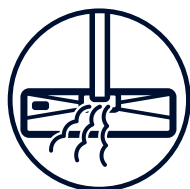

**TRIPLE SPRAY
JETS**



Rapid Mop

Lightweight but durable aluminium handle with foam grips and a hook and loop pad attachment. Comes with a choice of colour coded rings which can be fitted to the top of the handle.

993493 - Frame and handle only



Microfibre Pad

General cleaning blue pad.

993103

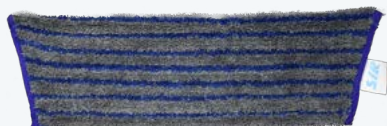

Performance Pad

Tough scrubbing strips for removing stubborn stains.

X0013000



Fringe Pad

General cleaning blue pad.

X0014000





Dual Mop

Using the Rapid Mop concept the Dual Mop was created. A spray flat mop system with an internal reservoir in the handle that sprays water ahead of the mop head. Once area is cleaned, flip the mop over to dry the floor.

S0047000 - Frame and handle only

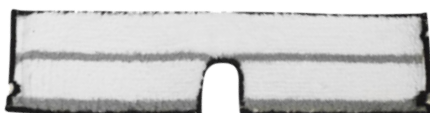

Cleaning Pad

For dual mop general cleaning.

S0044000



Super Drying Pad

For dual mop drying.

S0043000





Safety Signs

Keep People Safe

Risks should be controlled so that cleaners, and any other users of buildings, are kept safe and free from danger of injury.

SLIPS AND TRIPS

Slips and trips remain the single most common cause of major injury in UK workplaces. The process of cleaning can create slip and trip hazards, especially for those entering the area being cleaned, such as the cleaners. Examples include smooth floors left damp and slippery, trailing wires from a vacuum or buffing machine, which can present a trip hazard.

An effective cleaning regime requires a good management system to help you identify problem areas, decide what to do, act on decisions made and check that the steps have been effective. Good communication is also needed at all levels to ensure messages are effective and the right action is taken, e.g. between equipment and chemical suppliers to ensure suitability of a product for the type of contaminant and floor.

PREVENTION

Effective training and supervision is essential to ensure cleaning is undertaken to the correct standard. Cleaners need to be informed of their duties and why the cleaning needs to be undertaken in a particular way or at a particular time. Lack of understanding can lead to inappropriate short-cuts. Contamination is implicated in almost all slip accidents. Regular and effective cleaning to remove contamination helps to reduce accidents. People often slip on floors that have been left wet after cleaning. Stop pedestrian access to smooth wet floors by using barriers, locking doors, or cleaning in sections. Signs and cones only warn of a hazard, they do not prevent people from entering the area. If the spill is not visible, they are usually ignored.

SYR have redesigned the caution sign to offer a heavy duty, fit for purpose, low cost wet floor sign, and now, its made from 100% recycled plastic.



Safeguard-R

100% recycled durable moulded polypropylene safety warning sign. Printed using a unique in-mould print injection, which ensures high resolution images.

S0340000 - Caution sign



Every year this product will prevent the equivalent of 250,000 plastic bottles from going to landfill

Our eco distancing stickers are an ideal and easy way to set social distancing markers and use less plastic and save money at the same time!



SAVE PLASTIC



RE-USE SIGN

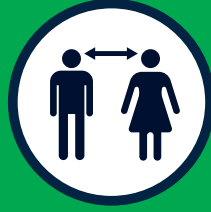

SAVE LIVES



Distancing Stickers



The peel on and off stickers fit onto your Safeguard-R signs meaning you can reuse your current safety sign, reducing waste and saving you money in the process.

S0358000 - Labels



**STICK ON LABEL,
SAVE PLASTIC**



**SOCIAL DISTANCE,
SAVE LIVES**



**PEEL OFF LABEL,
SAVE THE PLANET**

The super speedy solution for emergency spillages



FEATURES

- > Easy to store
- > Highly visible
- > Faster mop process
- > Durable tool holders
- > Minimal water usage
- > Light and easy to transport
- > Complete moisture removal
- > Reduced chemical consumption

KIT CONTAINS:

- 1x Rapid Response Cone
- 1x Dual Mop
- 2x Microfibre Heads
- 2x Dry Mophead
- 1x Lipped Lobby Pan
- 1x Squeegee Brush



Spill Management Kit

The premium spill kit. Sweep up breakages, squeegee and mop the floor and leave it dry. Colour coded squeegee brush.

- S0204291 - Red ●
- S0204292 - Blue ●
- S0204293 - Green ●
- S0204294 - Yellow ●



1 MST Pad Covers the Same Surface Area as 30 Rolls of Paper*

***based on average use and conditions**

Blue roll has a number of key properties that make it particularly useful across a multitude of working environments and tasks. Unfortunately it is single use, cannot be recycled and is over consumed and used inappropriately. It is also very often combined with excess chemical dispensing, which not only leaves surfaces looking unclean and full of smears, but also increases cleaning costs.

So let us introduce you to another option.

SYR Multi Surface Cleaning Tool provides a more cost effective solution with superior cleaning results and can complete up to 80% of the tasks blue roll is commonly used for.

**SCAN QR CODE TO FIND
OUT HOW THE MST CAN
REDUCE BLUE ROLL USE**





Multi Surface Tool (MST)

Can be used on internal windows, mirrors, glass areas and a multitude of hard surfaces. The surface is left perfectly clean, instantly dry and smear-free.

994258 - MST Frame only



Interchange Handle
Multi Surface Tool is also Interchange compatible for high level cleaning. See page 07 for Interchange handles.

> Three styles of microfiber heads are all available to purchase separately:



White Pad

For use on glass, mirrors, internal windows, digital displays and stainless steel. S0176000



Blue Pad

For use on laminate wood and in general areas. Removable colour coded tabs. 994226



Performance Pad

Tough scrubbing strips for removing stubborn stains. S0177000



USING AN MST INSTEAD OF PAPER ROLL GIVES YOU A 97% COST REDUCTION, SAVING £ 571.08 PER YEAR.



Complete MST kit

Complete kit contains 600ml bottle, white trigger spray, 5 blue microfiber pads and an MST tool. 994289 - Complete kit

Made from 100% recycled polyester



WHITE FLOOR PAD

Non-abrasive for polishing floors to produce high gloss finish

940845	6"	940544	10"	940127	14"	940131	18"
940846	7"	940849	11"	940128	15"	940852	19"
940847	8"	940850	12"	940129	16"	940853	20"
940848	9"	940851	13"	940130	17"	940854	21"

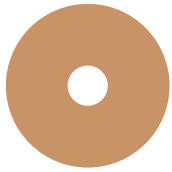

TAN FLOOR PAD

Light cleaning and dry buffing on traditional floors. Removes scuffs and black heel marks. Produces high gloss shine.

940831	6"	940543	10"	940122	14"	940126	18"
940832	7"	940835	11"	940123	15"	940838	19"
940833	8"	940836	12"	940124	16"	940839	20"
940834	9"	940837	13"	940125	17"	940840	21"



RED FLOOR PAD

Dry buffing, ideal for auto scrubber. Restores gloss while removing dirt and scuff marks.

940794	6"	940539	10"	940102	14"	940106	18"
940795	7"	940798	11"	940103	15"	940811	19"
940796	8"	940799	12"	940104	16"	940812	20"
940797	9"	940810	13"	940105	17"	940813	21"



MAROON FLOOR PAD

Dry or spray buffing, ideal for auto scrubber. Restores gloss while removing dirt and scuff marks.

940754	6"	940546	10"	940479	14"	940483	18"
940755	7"	940749	11"	940480	15"	940760	19"
940756	8"	940758	12"	940481	16"	940761	20"
940757	9"	940759	13"	940482	17"	940762	21"



BLUE FLOOR PAD

Wet scrubbing or medium duty spray cleaning. Removes heavy dirt and scuff marks.

940781	6"	940542	10"	940117	14"	940121	18"
940782	7"	940750	11"	940118	15"	940787	19"
940783	8"	940785	12"	940119	16"	940788	20"
940784	9"	940786	13"	940120	17"	940789	21"



GREEN FLOOR PAD

Heavy duty wet scrubbing or light stripping pad for heavily soiled areas.

940767	6"	940541	10"	940112	14"	940116	18"
940768	7"	940771	11"	940113	15"	940774	19"
940769	8"	940772	12"	940114	16"	940775	20"
940770	9"	940773	13"	940115	17"	940776	21"



BLACK FLOOR PAD

For heavy duty wet stripping. Very aggressive to remove wax, dirt and any finish.

940818	6"	940540	10"	940107	14"	940111	18"
940819	7"	940751	11"	940108	15"	940824	19"
940820	8"	940822	12"	940109	16"	940825	20"
940821	9"	940823	13"	940110	17"	940826	21"





← LEAST TO MOST ABRASIVE →

SYR master floor pads are a complete line of high quality superior performance pads to deliver a masterful floor care programme.

- Exceed at soil removal and absorption of the soil residue without impairing performance due to clogging
- Cushion fit to the contours of uneven floors
- Splinter free non clogging pads
- High density fibres and long lasting abrasives
- Centre hole punch-out for attachment to most rotary floor machines
- 25mm thick floor pads for rotary floor machines operating at 175rpm to 350rpm
- Wide choice of pads available to cover all floor maintenance tasks
- Suitable for most hard floor surfaces

SYR 6 Principles of Corporate Social Responsibility (CSR)

1 THE ENVIRONMENT

We take our environmental and social responsibility extremely seriously and we are committed to developing our business towards ecological, social and economic sustainability.

2 FAIR OPERATING

We will treat all current or potential employees, business partners and other stakeholders honestly and fairly and without prejudice.

3 COMMUNITY

We are committed to making a positive contribution to the communities in which we operate.

4 EMPLOYEE RELATIONS

Our staff are our most important asset. Within our staff is embedded our standards, our culture, our business ethos and our future.

5 STAKEHOLDERS

SYR strive to ensure that everyone with external trading and other relationships understand the standards of business engagement expected of them.

6 SUSTAINABLE DEVELOPMENT

We recognise the opportunity to develop the business sustainably which creates value for the benefit of our business and shareholders.





WE ARE CLEANING EXPERTS, NOT SALES REPS



SYR FOCUS

Changing the Way You Think About Cleaning

Every environment we encounter is different and our FOCUS team use their expertise to evaluate these unique challenges and provide solutions. We look at every little detail - so you don't have to - and recommend new procedures and equipment which will help your business unlock the key to your green cleaning success story.



**EXPLORE LATEST
INNOVATION**



**IMPROVE
STANDARDS**



**CREATE BESPOKE
SOLUTIONS**



**DRIVE
SUSTAINABILITY**

Our FOCUS team are highly skilled technical advisors with years of industry experience, combined with a passion for advancing cleaning practices. With an investigative, site-focused approach, they can analyse your current cleaning practices, producing a detailed report which offers recommendations and tailored solutions for your business. And when you are ready, they will even train and support your cleaning team – providing workshops, videos, training materials and multiple site visits to help you embed the changes.

Book an Evaluation Today 

If you are interested in booking our Focus team for an on-site assessment to help you become greener whilst becoming cleaner you can contact them via email or telephone:

focus.team@syrcclean.com
01384 421421

Alternatively, you can find out more about our Focus team and the support they can offer your business on our website at:

www.syrcclean.com/meet-focus-team

EXCELLENCE IN CLEANING SINCE 1954

Since the very beginning, our unique cleaning systems have been carefully designed and built to last, an ethos that is still very present in everything we manufacture today. Innovation and invention is very much at the heart of who we are, with our Research and Development team always busy creating new products to bring to the market. Our global growth has proceeded at such a rate since 1954 that today we have three manufacturing bases in Great Britain, USA and China.

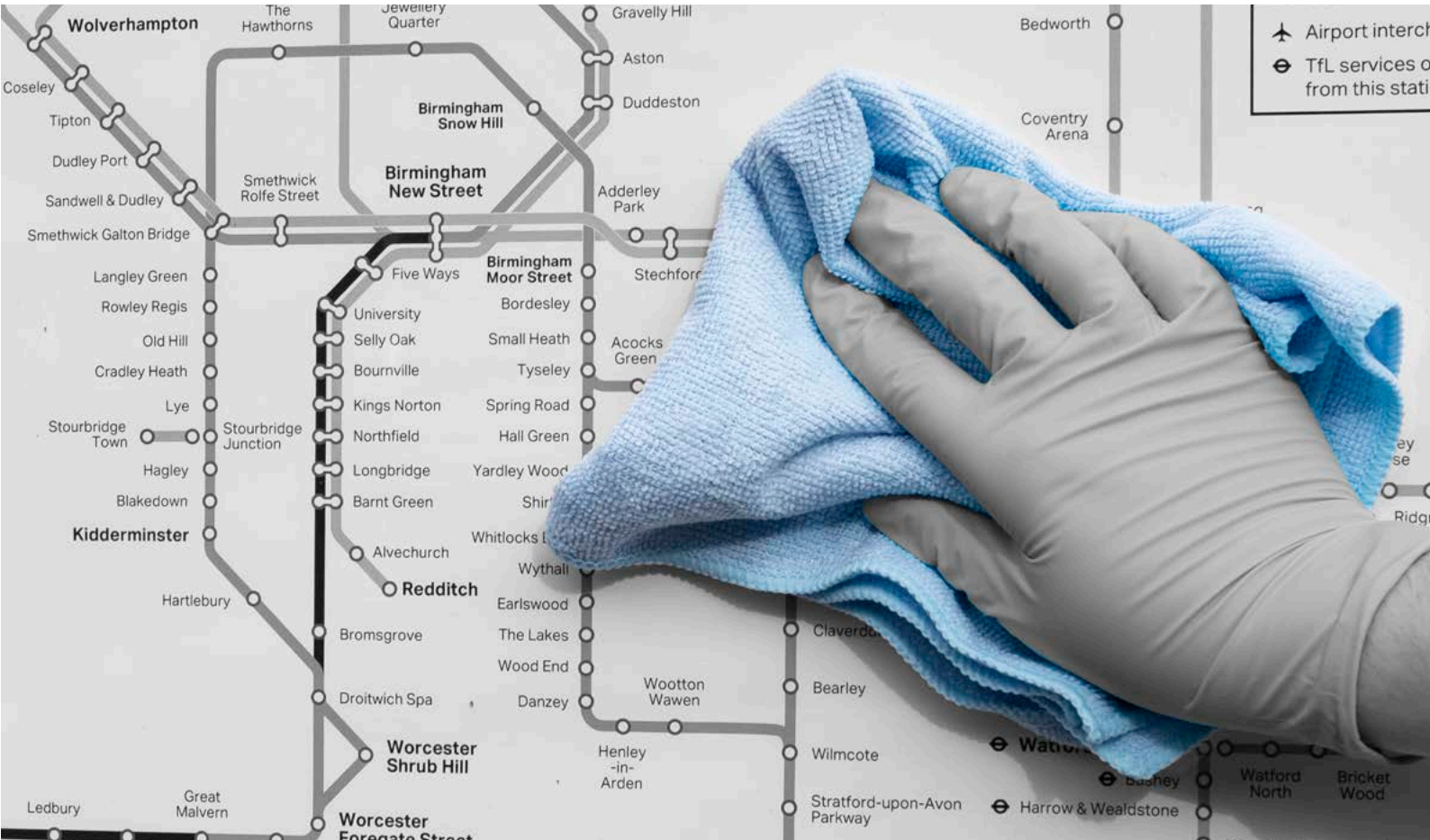

CONTACT US

Please give us a call to have a chat about any of our products or services and how we can help your business.

PHONE: 01384 421421

ONLINE

Email
contact@syrcclean.com
Web
syrcclean.com

OFFICE

Scot Young Research Ltd,
Lye By-Pass, Lye, Stourbridge,
West Midlands, DY9 8HG,
United Kingdom

OFFICE HOURS

Mon-Thurs
8:30am–5pm
Fri
8:30am–3:30pm

www.syrclean.com



©2020, Scot Young Research Ltd,
Registered in England No. 481830. Lye By-Pass, Lye,
Stourbridge, West Midlands, DY9 8HG, UK